

# 环形端头

## Sta-Kon® 环形、叉形和锁定叉形端头



- 全套的安装工具，设计与端头相配套。
- 第一个获得军用压力连接的产品，多种款式可用于军用领域
- Sta-Kon® 产品超出军事的测试规范要求，如UL和CSA
- 包括特大的金属压接筒，用于手柄绝缘
- 乙烯基类绝缘材料和裸露的 Sta-Kon® 端头采用铜焊接缝的电线压接筒，可以在压接筒任何位置弯曲。
- 可以使用压接工具安装，其具有单压头或双压头（推荐用于实芯线）
- 锯齿状的压接筒增加了其对电线的握持力
- 每个端头舌片上具有线规标记色
- 可以使用压接工具安装，其具有单压头或双压头（推荐用于实芯线）
- 电解铜的构造，具有高导电率
- 每个端头舌片上具有线规标识

## 列表

Sta-Kon® 环形、叉形和锁定叉形端头是经过 UL® 486A/B 标准测试，双向中接管符合UL 486C标准，可分断式连接器符合UL 310标准，所有产品符合CSA 22.2标准。



## 尼龙绝缘环形端头

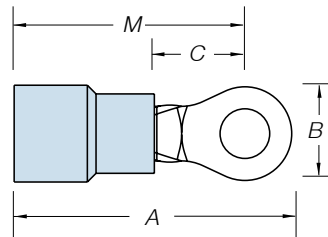

产品编号	包装件数	线规范围	最大值 (IN)	螺栓孔	推荐工具	尺寸				材料厚度
						A	B	C	M	
RZ22-2**	100	26-22	.083	#2	ERG4006	.57	.14	.13	.49	.02
RZ22-4**	100	26-22	.083	#4		.65	.21	.20	.54	
RZ22-6**	100	26-22	.083	#6		.65	.21	.20	.54	
RZ22-8**	100	26-22	.083	#8		.75	.25	.23	.62	
RZ22-10**	100	26-22	.083	#10		.75	.25	.23	.62	
RAX23*	1,000	26-24	.125	#2	WT145A	.66	.14	.14	.59	.02
RAX43*	1,000	26-24	.125	#4		.74	.20	.19	.64	
RAX63*	1,000	26-24	.125	#6		.84	.25	.22	.72	
RAX83*	1,000	26-24	.125	#8		.84	.25	.22	.72	
RAX103*	1,000	26-24	.125	#10		.84	.25	.24	.72	
RA18-4	100	22-16	.136	#4	ERG4001	.72	.23	.14	.59	.03
RA323	1,000	22-16	.136	#4		.72	.23	.14	.59	
RA333	1,000	22-16	.136	#6		.72	.23	.14	.59	
RA18-6	100	22-16	.136	#6		.86	.26	.25	.71	

产品编号	包装件数	线规范围	最大值 (IN)	螺栓孔	推荐工具	尺寸				材料厚度
						A	B	C	M	
RA853	1,000	22-16	.136	#6	WT145A	.86	.26	.25	.71	.03
RA18-8	100	22-16	.136	#8		.89	.26	.25	.71	
RA833	1,000	22-16	.136	#8		.86	.26	.25	.71	
RA863	1,000	22-16	.136	#8		.89	.26	.25	.71	
RA18-10	100	22-16	.136	#10		.89	.31	.25	.71	
RA873	1,000	22-16	.136	#10	ERG4001	.89	.31	.25	.71	.03
RA18-14	100	22-16	.136	1/4"		1.10	.46	.31	.84	
RA713	1,000	22-16	.136	1/4"		1.10	.46	.31	.84	
RA18-516	100	22-16	.136	5/16"		1.10	.46	.31	.84	
RA723	1,000	22-16	.136	5/16"		1.10	.46	.31	.84	
RA18-38	100	22-16	.136	3/8"	ERG4001	1.20	.53	.35	.87	.03
RA733	1,000	22-16	.136	3/8"		1.20	.53	.35	.87	
RA18-12	100	22-16	.136	1/2"		1.30	.72	.50	.92	
RA753	1,000	22-16	.136	1/2"	1.30	.72	.50	.92		

\* 未获UL或CSA认证

\*\* 仅获CSA认证

# 环形端头

## 尼龙绝缘环形端头 (续)

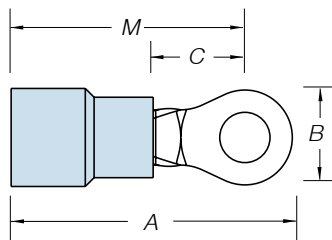

产品编号	包装件数	线规范围	最大值 (IN)	螺栓孔	推荐工具	尺寸				材料厚度
						A	B	C	M	
RB14-4	100	18-14	.162	#4	ERG4001	.72	.26	.14	.59	.03
RB1323	1,000	18-14	.162	#4		.72	.26	.14	.59	
RB14-6	100	18-14	.162	#6		.89	.31	.25	.71	
RB853	1,000	18-14	.162	#6		.89	.31	.25	.71	
RB1333	1,000	18-14	.162	#6		.74	.26	.14	.59	
RB14-8	100	18-14	.162	#8		.89	.31	.25	.71	
RB863	1,000	18-14	.162	#8		.89	.31	.25	.71	
RB14-10	100	18-14	.162	#10		.89	.31	.25	.71	
RB873	1,000	18-14	.162	#10		.89	.31	.25	.71	
RB14-14	100	18-14	.162	1/4"		1.08	.47	.31	.81	
RB713	1,000	18-14	.162	1/4"		1.08	.47	.31	.81	
RB14-516	100	18-14	.162	5/16"		1.08	.47	.31	.84	
RB723	1,000	18-14	.162	5/16"		1.08	.47	.31	.84	
RB14-38	100	18-14	.162	3/8"		1.17	.53	.35	.87	
RB733	1,000	18-14	.162	3/8"		1.17	.53	.35	.87	
RB14-12	100	18-14	.162	1/2"		1.25	.72	.50	.90	
RB753	1,000	18-14	.162	1/2"		1.25	.72	.50	.90	

产品编号	包装件数	线规范围	最大值 (IN)	螺栓孔	推荐工具	尺寸				材料厚度
						A	B	C	M	
RC10-6	50	12-10	.210	#6	ERG4001	1.00	.37	.27	.81	.04
RC333	500	12-10	.210	#6		1.00	.37	.27	.81	
RC10-8	50	12-10	.210	#8		1.00	.37	.27	.81	
RC863	500	12-10	.210	#8		1.00	.37	.27	.81	
RC10-10	50	12-10	.210	#10		1.00	.37	.27	.81	
RC363	500	12-10	.210	#10		1.00	.37	.27	.81	
RC10-14	50	12-10	.210	1/4"		1.12	.53	.32	.86	
RC713	500	12-10	.210	1/4"		1.12	.53	.32	.86	
RC10-516	50	12-10	.210	5/16"		1.21	.53	.31	.94	
RC703	500	12-10	.210	5/16"		1.21	.53	.31	.94	
RC10-38	50	12-10	.210	3/8"		1.27	.59	.35	.98	
RC733	500	12-10	.210	3/8"		1.27	.59	.35	.98	
RC10-12	50	12-10	.210	1/2"		1.37	.72	.52	1.02	
RC753	500	12-10	.210	1/2"		1.37	.72	.52	1.02	

## 尼龙绝缘环形端头—膨胀式入口

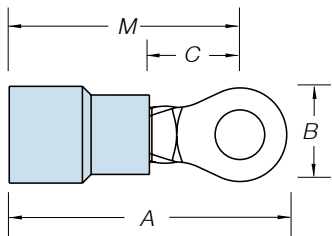

产品编号	包装件数	线规范围	最大值 (IN)	螺栓孔	推荐工具	尺寸				材料厚度
						A	B	C	M	
RB14-4X	100	18-14	.190	#4	ER4001	.80	.26	.14	.67	.03
RB14-6X	100	18-14	.190	#6		.95	.31	.25	.79	
RB854	1,000	18-14	.190	#6		.95	.31	.25	.79	
RB14-8X	100	18-14	.190	#8		.95	.31	.25	.79	
RB864	1,000	18-14	.190	#8		.95	.31	.25	.79	
RB14-10X	100	18-14	.190	#10		.95	.31	.25	.79	
RB874	1,000	18-14	.190	#10		.95	.31	.25	.79	
RB14-14X	100	18-14	.190	1/4"		1.16	.47	.31	.92	
RB714	1,000	18-14	.190	1/4"		1.16	.47	.31	.92	
RB14-516X	100	18-14	.190	5/16"		1.16	.47	.31	.92	
RB724	1,000	18-14	.190	5/16"		1.16	.47	.31	.92	
RB14-38X	100	18-14	.190	3/8"		1.25	.53	.42	.95	
RB734	1,000	18-14	.190	3/8"		1.25	.53	.42	.95	

产品编号	包装件数	线规范围	最大值 (IN)	螺栓孔	推荐工具	尺寸				材料厚度
						A	B	C	M	
RC10-6X	50	12-10	.250	#6	ERG4001	1.10	.37	.27	.91	.04
RC334	500	12-10	.250	#6		1.10	.37	.27	.91	
RC10-8X	50	12-10	.250	#8		1.10	.37	.27	.91	
RC864	500	12-10	.250	#8		1.10	.37	.27	.91	
RC10-10X	50	12-10	.250	#10		1.10	.37	.27	.91	
RC364	500	12-10	.250	#10		1.10	.37	.27	.91	
RC10-14X	50	12-10	.250	1/4"		1.22	.53	.32	.96	
RC714	500	12-10	.250	1/4"		1.22	.53	.32	.96	
RC10-516X	50	12-10	.250	5/16"		1.32	.53	.31	1.05	
RC704	500	12-10	.250	5/16"		1.32	.53	.31	1.05	
RC10-38X	50	12-10	.250	3/8"		1.38	.59	.48	1.09	
RC734	500	12-10	.250	3/8"		1.38	.59	.48	1.09	
RC10-12X	50	12-10	.250	1/2"		1.48	.72	.52	1.13	

UL认证文件E9809

# 环形端头

## 尼龙绝缘大环形端头

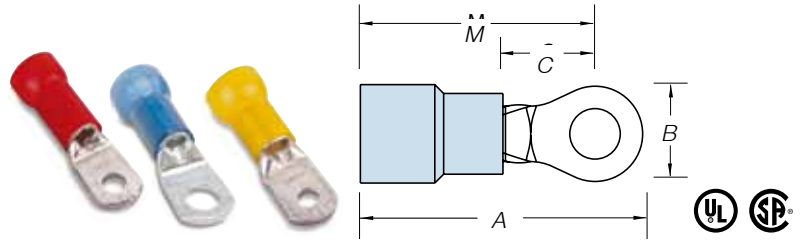

产品编号	包装件数	线规范围	最大值 (IN)	螺栓孔	推荐工具	尺寸				材料厚度		
						A	B	C	M			
柔性等级 41/24												
RD167	200	8	.340	#8	ERG4007	1.48	.42	.28	1.29	.04		
RD8-10	25	8	.340	#10		1.48	.42	.28	1.29			
RD367	200	8	.340	#10		1.48	.42	.28	1.29			
RD8-14	25	8	.340	1/4"		1.54	.46	.36	1.32			
RD717	200	8	.340	1/4"		1.54	.46	.36	1.32			
RD8-516	25	8	.340	5/16"		1.63	.57	.36	1.35			
RD727	200	8	.340	5/16"		1.63	.57	.36	1.35			
RD8-38	25	8	.340	3/8"		1.63	.57	.36	1.35			
RD737	200	8	.340	3/8"		1.63	.57	.36	1.35			
RD8-12*	25	8	.310	1/2"		TBM6S	1.79	.82	.55		1.39	
RD757*	200	8	.310	1/2"	1.79		.82	.55	1.39			
RD10161	200	8AN	.270	#8	ERG4007	1.40	.41	.24	1.20	.04		
RD10361	200	8AN	.270	#10		1.40	.41	.24	1.20			
RD10711	200	8AN	.270	1/4"		1.45	.45	.27	1.22			
RD10721	200	8AN	.270	5/16"		1.53	.56	.34	1.25			
RD10731	200	8AN	.270	3/8"		1.53	.56	.34	1.25			
柔性等级 63/24												
RE6-10	20	6	.420	#10	ERG4007	1.65	.49	.28	1.40	.04		
RE267	200	6	.420	#10		1.65	.49	.28	1.40			
RE6-14	20	6	.420	1/4"		1.65	.49	.28	1.40			
RE717	200	6	.420	1/4"		1.65	.49	.28	1.40			
RE6-516	20	6	.420	5/16"		1.76	.61	.34	1.47			
RE727	200	6	.420	5/16"		1.76	.61	.34	1.47			
RE6-38	20	6	.420	3/8"	TBM6S	1.76	.61	.34	1.47	.04		
RE737	200	6	.420	3/8"		1.76	.61	.34	1.47			
RE6-12*	20	6	.395	1/2"		1.83	.82	.55	1.43			
RE757*	200	6	.395	1/2"	1.83	.82	.55	1.43				
RE10261	200	6AN	.315	#10	ERG4007	1.55	.49	.24	1.31	.04		
RE10711	200	6AN	.315	1/4"		1.55	.49	.27	1.31			
RE10721	200	6AN	.315	5/16"		1.70	.60	.34	1.40			
RE10731	200	6AN	.315	3/8"		1.70	.60	.34	1.40			
柔性等级 105/24												
RF4-10	15	4	.510	#10	TBM6S	1.76	.56	.36	1.49	.04		
RF267	100	4	.510	#10		1.76	.56	.36	1.49			
RF4-14	15	4	.510	1/4"		1.76	.56	.36	1.49			
RF717	100	4	.510	1/4"		1.76	.56	.36	1.49			
RF4-516	15	4	.510	5/16"		1.84	.62	.35	1.53			
RF727	100	4	.510	5/16"		1.84	.62	.35	1.53			
RF4-38	15	4	.510	3/8"		1.84	.62	.35	1.53			
RF737	100	4	.510	3/8"		1.84	.62	.35	1.53			
RF757*	100	4	.500	1/2"		1.90	.82	.55	1.49			
RF10261	100	4AN	.380	#10		TBM6S	1.78	.55	.30		1.51	.04
RF10711	100	4AN	.380	1/4"	1.78		.55	.30	1.51			
RF10721	100	4AN	.380	5/16"	1.80		.62	.34	1.49			
RF10731	100	4AN	.380	3/8"	1.80		.62	.34	1.49			
柔性等级 105/24												
RG2-10	10	2	.588	#10	TBM6S		2.15	.69	.40	1.83	.05	
RG267	50	2	.588	#10			2.15	.69	.40	1.83		
RG2-14	10	2	.588	1/4"			2.15	.69	.40	1.83		
RG717	50	2	.588	1/4"			2.15	.69	.40	1.83		
RG2-516	10	2	.588	5/16"			2.15	.69	.40	1.83		
RG727	50	2	.588	5/16"		2.15	.69	.40	1.83			
RG2-38	10	2	.588	3/8"		2.15	.69	.40	1.83			
RG737	50	2	.588	3/8"		2.15	.69	.40	1.83			
RG2-12	10	2	.588	1/2"		2.35	.80	.49	1.93			
RG757	50	2	.588	1/2"		2.35	.80	.49	1.93			
RG9711	50	2AN	.453	1/4"	TBM6S	2.07	.69	.40	1.74	.05		
RG9731	50	2AN	.453	3/8"		2.07	.69	.40	1.74			
RG9751	50	2AN	.453	1/2"		2.26	.80	.49	1.84			
RH717	50	1/0	.629	1/4"	TBM6S	2.14	.77	.43	1.81	.06		
RH727	50	1/0	.629	5/16"		2.14	.77	.43	1.81			
RH737	50	1/0	.629	3/8"		2.14	.77	.43	1.81			
RH757	50	1/0	.629	1/2"		2.34	.77	.54	1.90			
RH9711	50	1AN	.500	1/4"		2.14	.77	.44	1.81			
RH9731	50	1AN	.500	3/8"		2.14	.77	.44	1.81			
RH9751	50	1AN	.500	1/2"		2.34	.77	.54	1.90			
RJ717	100	2/0	.675	1/4"		2.34	.83	.46	1.96			
RJ727	100	2/0	.675	5/16"		2.34	.83	.46	1.96			
RJ737	100	2/0	.675	3/8"		2.34	.83	.46	1.96			
RJ757	100	2/0	.675	1/2"	2.48	.89	.54	2.03				
RJ9711	50	1/0AN	.550	1/4"	TBM6S	2.35	.83	.46	1.97	.06		
RJ9731	50	1/0AN	.550	3/8"		2.35	.83	.46	1.97			
RJ9751	50	1/0AN	.550	1/2"		2.49	.89	.55	2.04			
RK717	25	3/0	.765	1/4"	TBM6S	2.60	.93	.54	2.21	.07		
RK727	25	3/0	.765	5/16"		2.60	.93	.54	2.21			
RK737	25	3/0	.765	3/8"		2.60	.93	.54	2.21			
RK9731	100	2/0AN	.610	3/8"	TBM6S	2.52	.93	.55	2.14	.07		
RK9751	100	2/0AN	.610	1/2"		2.60	.93	.55	2.15			
RL737	25	4/0	.785	3/8"		2.83	1.04	.57	2.35			
RL757	25	4/0	.785	1/2"	2.83	1.04	.57	2.35				
RL9731	25	3/0AN	.680	3/8"	TBM6S	2.83	1.04	.57	2.36	.07		
RL9751	25	3/0AN	.680	1/2"		2.83	1.04	.57	2.36			
RM737	20	250kcmil	.868	3/8"	TBM6S	3.00	1.13	.65	2.51	.07		
RM747	20	250kcmil	.868	7/16"		3.00	1.13	.65	2.51			
RM757	20	250kcmil	.868	1/2"		3.00	1.13	.65	2.51			
RM9731	20	4/0AN	.750	3/8"		3.00	1.13	.66	2.51			
RM9751	20	4/0AN	.750	1/2"		3.00	1.13	.66	2.51			

\*铜焊接缝 AN = 航空电缆

# 环形端头

超长 PVC 套筒提供了额外的保护

乙烯基绝缘环形端头

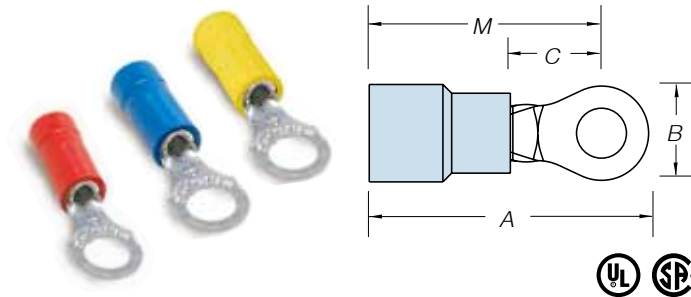

产品编号	包装件数	线规范围	最大值 (IN)	螺孔	推荐工具	尺寸				材料厚度
						A	B	C	M	
18RA-4	100	22-16	.150	#4		.97	.31	.27	.81	.03
RA77	1,000	22-16	.150	#4		.97	.31	.27	.81	
18RA-6	100	22-16	.150	#6		.94	.25	.27	.81	
RA857	1,000	22-16	.150	#6		.94	.25	.27	.81	
18RA-8	100	22-16	.150	#8		.97	.31	.27	.81	
RA867	1,000	22-16	.150	#8		.97	.31	.27	.81	
18RA-10	100	22-16	.150	#10		.97	.31	.27	.81	
RA877	1,000	22-16	.150	#10		.97	.31	.27	.81	
18RA-14	100	22-16	.150	1/4"		1.13	.50	.37	.88	
RA717	1,000	22-16	.150	1/4"		1.13	.50	.37	.88	
18RA-516	100	22-16	.150	5/16"		1.13	.50	.37	.88	
RA727	1,000	22-16	.150	5/16"		1.13	.50	.37	.88	
18RA-38	100	22-16	.150	3/8"		1.24	.54	.37	.91	
RA737	1,000	22-16	.150	3/8"		1.24	.54	.37	.91	
14RB-4	100	18-14	.170	#4	ERG4001	.94	.25	.27	.81	
RB1327	1,000	18-14	.170	#4		.94	.25	.27	.81	
14RB-6	100	18-14	.170	#6		.97	.31	.27	.81	
RB857	1,000	18-14	.170	#6		.97	.31	.27	.81	
14RB-8	100	18-14	.170	#8		.97	.31	.27	.81	
RB867	1,000	18-14	.170	#8		.97	.31	.27	.81	
14RB-10	100	18-14	.170	#10		.97	.31	.27	.81	
RB877	1,000	18-14	.170	#10		.97	.31	.27	.81	
14RB-14	100	18-14	.170	1/4"		1.14	.50	.38	.89	
RB717	1,000	18-14	.170	1/4"		1.14	.50	.38	.89	
14RB-516	100	18-14	.170	5/16"		1.15	.50	.38	.89	
RB727	1,000	18-14	.170	5/16"		1.15	.50	.38	.89	
14RB-38	100	18-14	.170	3/8"		1.16	.54	.38	.91	
RB737	1,000	18-14	.170	3/8"		1.16	.54	.38	.91	
10RC-6	50	12-10	.210	#6			1.06	.31	.27	.90
RC337	500	12-10	.210	#6			1.06	.31	.27	.90
10RC-8	50	12-10	.210	#8	1.06		.31	.27	.90	
RC777	500	12-10	.210	#8	1.06		.31	.27	.90	
10RC-10	50	12-10	.210	#10	1.06		.31	.27	.90	
RC367	500	12-10	.210	#10	1.06		.31	.27	.90	
10RC-14	50	12-10	.210	1/4"	1.16		.50	.27	.90	
RC717	500	12-10	.210	1/4"	1.16		.50	.27	.90	
10RC-516	50	12-10	.210	5/16"	1.17		.50	.37	.92	
RC707	500	12-10	.210	5/16"	1.17		.50	.37	.92	
10RC-38	50	12-10	.210	3/8"	1.29		.59	.44	.99	
RC737	500	12-10	.210	3/8"	1.29		.59	.44	.99	

用于厚壁绝缘的宽电缆入口

乙烯基绝缘环形端头 — 膨胀式绝缘

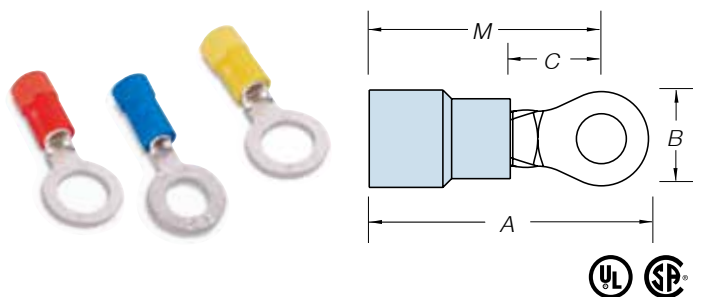

产品编号	包装件数	线规范围	最大值 (IN)	螺孔	推荐工具	尺寸				材料厚度
						A	B	C	M	
18RA-4X	100	22-16	.170	#4		.97	.31	.27	.81	.03
18RA-6X	100	22-16	.170	#6		.97	.31	.27	.81	
18RA-8X	100	22-16	.170	#8		.97	.31	.27	.81	
18RA-38X	100	22-16	.170	3/8"		1.15	.54	.35	.90	
RA857-170	1,000	22-16	.170	#6		.97	.31	.27	.81	
RA867-170	1,000	22-16	.170	#8		.97	.31	.27	.81	
18RA-10X	1,000	22-16	.170	#10		.97	.31	.27	.81	
RA877-170	1,000	22-16	.170	#10		.97	.31	.27	.81	
18RA-14X	100	22-16	.170	1/4"		1.13	.50	.37	.88	
RA727-170	1,000	22-16	.170	5/16"		1.13	.50	.37	.88	
14RB-4X	100	18-14	.200	#4	ERG4001	.94	.25	.27	.81	
14RB-6X	100	18-14	.200	#6		.97	.31	.27	.81	
RB857-200	1,000	18-14	.200	#6		.97	.31	.27	.81	
14RB-8X	100	18-14	.200	#8		.97	.31	.27	.81	
RB867-200	1,000	18-14	.200	#8		.97	.31	.27	.81	
14RB-10X	100	18-14	.200	#10		.97	.31	.27	.81	
RB877-200	1,000	18-14	.200	#10		.97	.31	.27	.81	
14RB-14X	100	18-14	.200	1/4"		1.14	.50	.38	.89	
RB717-200	1,000	18-14	.200	1/4"		1.14	.50	.38	.89	
14RB-516X	100	18-14	.200	5/16"		1.15	.50	.38	.89	
14RB-38X	100	18-14	.200	3/8"	1.16	.54	.35	.91		
10RC-6X	50	12-10	.250	#6		1.06	.31	.27	.90	
RC337-250	500	12-10	.250	#6		1.06	.31	.27	.90	
10RC-8X	50	12-10	.250	#8		1.06	.31	.27	.90	
RC777-250	500	12-10	.250	#8		1.06	.31	.27	.90	
10RC-10X	50	12-10	.250	#10		1.06	.31	.27	.90	
RC367-250	500	12-10	.250	#10		1.06	.31	.27	.90	
10RC-14X	50	12-10	.250	1/4"		1.16	.50	.27	.90	
RC717-250	500	12-10	.250	1/4"		1.16	.50	.27	.90	
10RC-516X	50	12-10	.250	5/16"		1.17	.50	.37	.92	
10RC-38X	50	12-10	.250	3/8"		1.29	.59	.44	.99	
RC737-250	500	12-10	.250	3/8"	1.29	.59	.44	.99		

用于多种符合UL认证文件 E9609要求的电缆组合，参见第8页

# 环形端头

## 乙烯基绝缘大环形端头

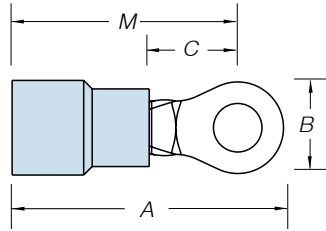

产品编号	导线规格范围	最大值 (IN)	螺栓孔	推荐工具	尺寸				材料厚度
					A	B	C	M	
RDV167	8	.340	#8	ERG4007	1.48	.42	.28	1.17	.04
RDV367	8	.340	#10		1.48	.42	.28	1.17	
RDV717	8	.340	1/4"		1.54	.46	.36	1.20	
RDV727	8	.340	5/16"		1.63	.57	.36	1.23	
RDV737	8	.340	3/8"		1.63	.57	.36	1.23	
RDV757*	8	.310	1/2"	TBM6S	1.79	.82	.55	1.27	
REV267	6	.420	#10	ERG4007	1.65	.45	.28	1.23	
REV717	6	.420	1/4"		1.65	.49	.28	1.23	
REV727	6	.420	5/16"		1.76	.61	.34	1.30	
REV737	6	.420	3/8"		1.76	.61	.34	1.30	
REV757*	6	.395	1/2"	TBM6S	1.83	.82	.55	1.26	

\*铜焊接缝

## 多种符合UL认证文件 E9609要求的电缆组合

TYPE (绝缘)	线缆规格 (AWG) 每边
RA (乙烯基) 环形和叉形	(1) #22 (1) #22 结合 (1) #20
RB (乙烯基) 环形和叉形	(1) #16 结合 (1) #20 (2) #18 (1) #18 结合 (1) #20 (3) #20 (2) #20 (2) #20 结合 (2) #22 (1) #20 结合 (3) #22 (3) #22
RC (乙烯基) 环形和叉形	(1) #12 结合 (1) #16 (1) #14 结合 (1) 或 (2) #16 (1) #14 结合 (1) 或 (2) #18 (2) #14 (3) #16 (2) #16 (1) #16 结合 (3) #18 (1) #16 结合 (2) #18 (1) #16 结合 (4) #18 (1) #16 结合 (3) #18
RCC (Vinyl)	(1) #12 结合 (1) #16 (1) #14 结合 (1) 或 (2) #16 (1) #14 结合 (1) 或 (2) #18 (2) #14 (3) #16 (2) #16 (1) #16 结合 (3) #18 (1) #16 结合 (2) #18 (4) #18
RAA (乙烯基)	(2) #22 (1) #22 结合 (1) #20
RBB (乙烯基)	(1) #16 结合 (1) #20 (2) #18 (1) #18 结合 (1) #20 (3) #20 (2) #20 (2) #20 结合 (2) #22 (1) #20 结合 (3) #22 (3) #22

## 推荐的手动工具为WT145C和WT2000。

- 未在多股线可分断式连接器上进行UL测试。
- 未在多股线尼龙端头上进行UL测试
- 未在多股线尼龙端头上进行UL测试

# 环形端头

电解铜结构，具有较高的电导率！

非绝缘环形端头

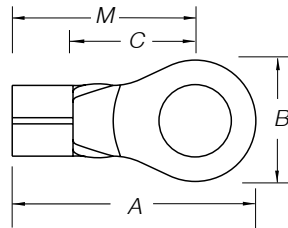

产品编号	导线规格范围	最大值 (IN)	螺栓孔	推荐工具	尺寸				材料厚度		
					A	B	C	M			
A18-4	100	22-16	#4	ERG4002	.75	.31	.27	.59	.03		
A18-6	100	22-16	#6		.72	.25	.27	.59			
A85	1,000	22-16	#6		.72	.25	.27	.59			
A18-8	100	22-16	#8		.75	.31	.27	.59			
A86	1,000	22-16	#8		.75	.31	.27	.59			
A18-10	100	22-16	#10		.75	.31	.27	.59			
A87	1,000	22-16	#10		.75	.31	.27	.59			
A18-14	100	22-16	1/4"		.92	.50	.37	.67			
A71	1,000	22-16	1/4"		.92	.50	.37	.67			
A18-516	100	22-16	5/16"		.92	.50	.37	.67			
A72	1,000	22-16	5/16"		.92	.50	.37	.67			
A18-38	100	22-16	3/8"		.99	.54	.35	.67			
A73	1,000	22-16	3/8"		.99	.54	.35	.67			
A18-12	100	22-16	1/2"		1.06	.72	.38	.70			
A75	1,000	22-16	1/2"		1.06	.72	.38	.70			
B14-4	100	18-14	#4		ERG4002 ERG4005	.72	.25	.27		.59	.04
B132	1,000	18-14	#4			.72	.25	.27		.59	
B14-6	100	18-14	#6			.72	.25	.27		.59	
B133	1,000	18-14	#6			.72	.25	.27		.59	
B14-8	100	18-14	#8			.75	.31	.27		.59	
B86	1,000	18-14	#8	.75		.31	.27	.59			
B14-10	100	18-14	#10	.75		.31	.27	.59			
B87	1,000	18-14	#10	.75		.31	.27	.59			
B14-14	100	18-14	1/4"	.93		.50	.38	.68			

铜焊接缝

产品编号	导线规格范围	最大值 (IN)	螺栓孔	推荐工具	尺寸				材料厚度	
					A	B	C	M		
B71	1,000	18-14	1/4"	ERG4002 ERG4005	.93	.50	.38	.68	.03	
B14-516	100	18-14	5/16"		.93	.50	.38	.68		
B72	1,000	18-14	5/16"		.93	.50	.38	.68		
B14-38	100	18-14	3/8"		.96	.54	.35	.68		
B73	1,000	18-14	3/8"		.96	.54	.35	.68		
B14-12	100	18-14	1/2"		1.06	.72	.38	.70		
B75-TB	1,000	18-14	1/2"		1.06	.72	.38	.70		
B85	1,000	18-14	#6		.75	.31	.27	.59		
B134	1,000	18-14	#8		.72	.25	.27	.59		
C10-6-SK	50	12-10	#6		.82	.31	.27	.66		.04
C33	500	12-10	#6		.82	.31	.27	.66		
C10-8-SK	50	12-10	#8		.82	.31	.27	.66		
C77	500	12-10	#8		.82	.31	.27	.66		
C10-10	50	12-10	#10		.85	.38	.27	.66		
C26	500	12-10	#10		.85	.38	.27	.66		
C36	500	12-10	#10		.82	.31	.27	.66		
C10-14	50	12-10	1/4"	.91	.50	.27	.66			
C71	500	12-10	1/4"	.91	.50	.27	.66			
C10-516	50	12-10	5/16"	.98	.50	.38	.73			
C70	500	12-10	5/16"	.98	.50	.38	.73			
C72	500	12-10	5/16"	1.10	.59	.45	.80			
C10-38	50	12-10	3/8"	1.10	.59	.45	.80			
C73	500	12-10	3/8"	1.10	.59	.45	.80			
C10-12	50	12-10	1/2"	1.21	.72	.38	.84			
C75	500	12-10	1/2"	1.21	.72	.38	.84			

# 环形端头

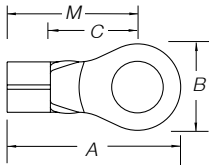

非绝缘大环形端头 — 铜焊接缝

产品编号	包装件数	导线规格范围	螺栓孔	推荐工具	尺寸				材料厚度	
					A	B	C	M		
D8-10	25	8	#10	TBM6S	1.09	.42	.34	.90	.06	
D36	200	8	#10		1.09	.42	.34	.90		
D26	200	8	#10		1.13	.48	.36	.90		
D8-14-SK	25	8	1/4"		1.13	.48	.36	.90		
D71	200	8	1/4"		1.13	.48	.36	.90		
D8-516	25	8	5/16"		1.32	.59	.49	1.03		
D72	200	8	5/16"		1.32	.59	.49	1.03		
D8-38	25	8	3/8"		1.32	.59	.49	1.03		
D73	200	8	3/8"		1.32	.59	.49	1.03		
D8-12	25	8	1/2"		1.49	.82	.55	1.09		
D75	200	8	1/2"		1.49	.82	.55	1.09		
E6-10	20	6	#10		1.13	.48	.36	.90		.07
E26	200	6	#10		1.13	.48	.36	.90		
E6-14	20	6	1/4"		1.13	.48	.36	.90		
E71	200	6	1/4"		1.13	.48	.36	.90		
E6-516	20	6	5/16"	1.32	.60	.49	1.03			
F4-10	20	4	#10	1.16	.48	.36	.93			
F26	200	4	#10	1.16	.48	.36	.93			
F4-14	20	4	1/4"	1.16	.48	.36	.93			
F71-TB	200	4	1/4"	1.16	.48	.36	.93			
F4-516	20	4	5/16"	1.35	.60	.49	1.06			
F72	200	4	5/16"	1.35	.60	.49	1.06			
F4-38	20	4	3/8"	1.35	.60	.49	1.06			
F73	200	4	3/8"	1.35	.60	.49	1.06			
F4-12	20	4	1/2"	1.52	.82	.55	1.11			
F75	200	4	1/2"	1.52	.82	.55	1.11			



产品编号	包装件数	导线规格范围	螺栓孔	推荐工具	尺寸				材料厚度
					A	B	C	M	
E72	200	6	5/16"	TBM6S	1.32	.60	.49	1.03	.06
E6-38	20	6	3/8"		1.32	.60	.49	1.03	
E73	200	6	3/8"		1.32	.60	.49	1.03	
E6-12	20	6	1/2"		1.49	.82	.55	1.08	
E75	200	6	1/2"		1.49	.82	.55	1.08	
F4-10	20	4	#10		1.16	.48	.36	.93	.07
F26	200	4	#10		1.16	.48	.36	.93	
F4-14	20	4	1/4"		1.16	.48	.36	.93	
F71-TB	200	4	1/4"		1.16	.48	.36	.93	
F4-516	20	4	5/16"		1.35	.60	.49	1.06	
F72	200	4	5/16"		1.35	.60	.49	1.06	
F4-38	20	4	3/8"		1.35	.60	.49	1.06	
F73	200	4	3/8"		1.35	.60	.49	1.06	
F4-12	20	4	1/2"		1.52	.82	.55	1.11	
F75	200	4	1/2"		1.52	.82	.55	1.11	

## 选择你需要的配置!

非绝缘大环形端头 — 管状

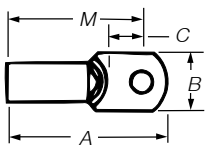

产品编号	包装件数	导线规格范围	螺栓孔	推荐工具	尺寸				材料厚度	
					A	B	C	M		
D10161	200	8/8AN	#8	ERG 4005	1.15	.41	.28	.95	.04	
D10361	200	8/8AN	#10		1.15	.41	.28	.95		
D10711	200	8/8AN	1/4"		1.20	.45	.36	.97		
D10721	200	8/8AN	5/16"		1.28	.56	.36	1.00		
D10731	200	8/8AN	3/8"		1.28	.56	.36	1.00		
D975*	200	8/8AN	1/2"	TBM6S	1.46	.83	.49	1.06		
E10261	200	6/6AN	#10	ERG 4005	1.26	.49	.24	1.02		
E10711	200	6/6AN	1/4"		1.26	.49	.27	.99		
E10721	200	6/6AN	5/16"		1.38	.60	.34	1.04		
E10731	200	6/6AN	3/8"		1.38	.60	.34	1.04		
F10261	100	4/4AN	#10	ERG 4008	1.37	.55	.30	1.07		
F10711	100	4/4AN	1/4"		1.37	.55	.30	1.07		
F10721	100	4/4AN	5/16"		1.42	.62	.34	1.08		
F10731	100	4/4AN	3/8"		1.42	.62	.34	1.08		
F975*	200	4/4AN	1/2"		TBM6S	1.49	.83	.45		1.10
G926	100	2/2AN	#10	TBM6S	1.59	.69	.40	1.26	.07	
G2-14	10	2/2AN	1/4"		1.59	.69	.40	1.26		
G971	100	2/2AN	5/16"		1.59	.69	.40	1.26		
G2-516	10	2/2AN	5/16"		1.59	.69	.40	1.26		
G972	100	2/2AN	5/16"		1.59	.69	.40	1.26		
G2-38	10	2/2AN	3/8"		1.59	.69	.40	1.26		
G973	100	2/2AN	3/8"		1.59	.69	.40	1.26		
G2-12	10	2/2AN	1/2"		1.79	.80	.49	1.36		
G975	100	2/2AN	1/2"		1.79	.80	.49	1.36		
H10-14	10	1AN-1/0	1/4"		ERG 4008	1.65	.77	.43		1.32
H971	100	1AN-1/0	1/4"			1.65	.77	.43		1.32
H972	100	1AN-1/0	5/16"			1.65	.77	.43		1.32
H973	100	1AN-1/0	3/8"			1.65	.77	.43		1.32
H975	100	1AN-1/0	1/2"			1.85	.77	.54		1.41
J971	50	1/0AN-2/0	1/4"		TBM6S	1.94	.84	.48		1.53
J972	50	1/0AN-2/0	5/16"	1.94		.84	.48	1.53		
J20-38	10	1/0AN-2/0	3/8"	1.84		.83	.46	1.46		
J973	50	1/0AN-2/0	3/8"	1.99		.84	.53	1.58		
J974	50	1/0AN-2/0	7/16"	1.99		.89	.51	1.56		
J975	50	1/0AN-2/0	1/2"	1.99		.89	.51	1.56		
J976	50	1/0AN-2/0	5/8"	1.99		.89	.51	1.56		
K971	50	2/0AN-3/0	1/4"	2.08		.93	.54	1.69		
K972	50	2/0AN-3/0	5/16"	2.08		.93	.54	1.69		
K30-38	5	2/0AN-3/0	3/8"	2.08		.93	.54	1.69		
K973	50	2/0AN-3/0	3/8"	2.08	.93	.54	1.69			
K974	50	2/0AN-3/0	7/16"	2.08	.93	.54	1.70			
K975	50	2/0AN-3/0	1/2"	2.08	.93	.54	1.70			
L971	50	3/0AN-4/0	1/4"	TBM6S	2.25	1.04	.57	1.77		
L972	50	3/0AN-4/0	5/16"		2.25	1.04	.57	1.77		
L40-38	5	3/0AN-4/0	3/8"		2.25	1.04	.57	1.77		
L973	50	3/0AN-4/0	3/8"		2.25	1.04	.57	1.77		
L974	50	3/0AN-4/0	7/16"		2.25	1.04	.57	1.77		
L975	50	3/0AN-4/0	1/2"		2.25	1.04	.57	1.77		
M972	50	4/0AN-250kcmil	5/16"		2.28	1.12	.62	1.90		
M250-38	5	4/0AN-250kcmil	3/8"		2.40	1.12	.65	1.91		
M973	50	4/0AN-250kcmil	3/8"		2.40	1.12	.65	1.91		
M974	50	4/0AN-250kcmil	7/16"		2.40	1.12	.65	1.91		
M975	50	4/0AN-250kcmil	1/2"	2.40	1.12	.65	1.91			



\*铜焊接缝

AN - 航空电缆

# 环形端头

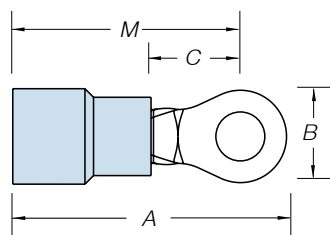

## 绝缘重型环形端头



产品编号	包装件数	导线规格范围	最大值 (IN)	螺栓孔	推荐工具	尺寸				材料厚度
						A	B	C	M	
<b>尼龙</b>										
RBC14-6	50	16-14 重型	.210	#6	WT2130A	.98	.25	.29	.85	.05
RBC14-8	50	16-14 重型	.210	#8		1.04	.39	.29	.85	
RBC863	500		.210	#8		1.04	.39	.29	.85	
RBC14-10	50	16-14 重型	.210	#10		1.04	.39	.29	.85	
RBC14-14	50	16-14 重型	.210	1/4"		1.10	.51	.29	.85	
RBC713	500		.210	1/4"		1.10	.51	.29	.85	
RBC14-516	50	16-14 重型	.210	5/16"		1.21	.54	.38	.94	
RBC14-38	50	16-14 重型	.210	3/8"		1.26	.63	.38	.94	
RBC14-12	50	16-14 重型	.210	1/2"		1.49	.76	.54	1.11	
RBC753	500		.210	1/2"		1.49	.76	.54	1.11	

## 塑料

14RBC-6	50	16-14 重型	.210	#6	WT2130A	1.06	.25	.29	.93	.05
RBC857	500		.210	#6		1.06	.25	.29	.93	
14RBC-8	50	16-14 重型	.210	#8		1.13	.39	.29	.93	
RBC867	500		.210	#8		1.13	.39	.29	.93	
14RBC-10	50	16-14 重型	.210	#10		1.13	.39	.29	.93	
RBC877	500		.210	#10		1.13	.39	.29	.93	
14RBC-14	50	16-14 重型	.210	1/4"		1.19	.51	.29	.93	
RBC717	500		.210	1/4"		1.19	.51	.29	.93	
14RBC-516	50	16-14 重型	.210	5/16"		1.29	.54	.38	1.03	
RBC727	500		.210	5/16"		1.29	.54	.38	1.03	
14RBC-38	50	16-14 重型	.210	3/8"		1.34	.63	.38	1.03	
RBC797	500		.210	3/8"		1.34	.63	.38	1.03	
14RBC-12	50	16-14 重型	.210	1/2"		1.57	.76	.54	1.19	
RB757	500		.210	1/2"		1.57	.76	.54	1.19	

## 重型端头解决方案!

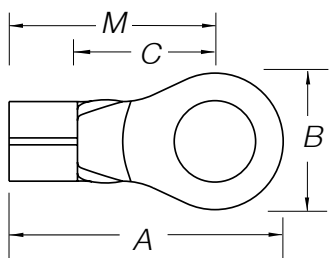

## 非绝缘重型环形端头



产品编号	包装件数	导线规格范围	螺栓孔	推荐工具	尺寸				材料厚度
					A	B	C	M	
BC14-6	50	16-14 重型	#6	ER4002 ERG4005	.81	.25	.29	.68	.05
BC85	500		#6		.81	.25	.29	.68	
BC14-8	50	16-14 重型	#8		.87	.39	.29	.68	
BC86	500		#8		.87	.39	.29	.68	
BC14-10	50	16-14 重型	#10		.87	.39	.29	.68	
BC87	500		#10		.87	.39	.29	.68	
BC14-14	50	16-14 重型	1/4"		.93	.51	.29	.68	
BC71	500		1/4"		.93	.51	.29	.68	
BC14-516	50	16-14 重型	5/16"		1.04	.54	.38	.77	
BC72	500		5/16"		1.04	.54	.38	.77	
BC14-38	50	16-14 重型	3/8"		1.09	.63	.38	.77	
BC79	500		3/8"		1.09	.63	.38	.77	
BC14-12	50	16-14 重型	1/2"		1.32	.76	.54	.94	
BC75	500		1/2"		1.32	.76	.54	.94	



# 环形端头

## NW系列镍铬合金线端头

高温非绝缘环形端头 — 最高 1200°F

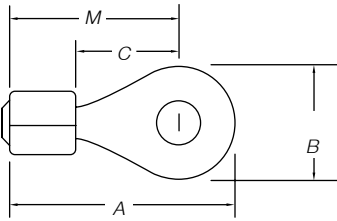

产品编号	包装件数	导线规格范围	每1000件重量(LBS)	螺栓孔	推荐工具	尺寸				材料厚度
						A	B	C	M	
NW18-10	100	20-18	2.5	#10	WT1377	.63	.31	.28	.38	.032
NW52	1,000	20-18	2.5	#8		.63	.31	.28	.38	
NW81	1,000	16-14	2.5	#6		.66	.31	.28	.51	.040
NW14-8	100	16-14	2.5	#8		.66	.31	.28	.51	
NW14-10	100	16-14	2.5	#10		.66	.31	.28	.51	
NW83	1,000	16-14	2.5	#10		.66	.31	.28	.51	
NW14-12	100	16-14	2.5	#12*		.66	.31	.28	.51	
NW84	1,000	16-14	2.5	#12*		.66	.31	.28	.51	
NW10-8	50	12-10	3	#8		.66	.31	.28	.51	
NW10-10	50	12-10	3	#10		.66	.31	.28	.51	
NW10-12	50	12-10	3	#12*		.66	.31	.28	.51	

\* #12 孔径小于 1/4" 孔径

## Tefzel® 绝缘环形 — 绝缘夹套

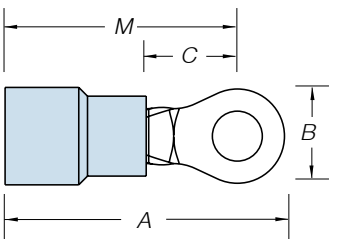

产品编号	包装件数	导线规格范围	每1000件重量(LBS)	螺栓孔	推荐工具	尺寸				材料厚度
						A	B	C	M	
RAT853	1,000	22-18	.140	#6	WT145C	.81	.25	.25	.69	.03
RAT863	1,000	22-18	.140	#8		.84	.31	.25	.69	
RAT873	1,000	22-18	.140	#10		.84	.31	.25	.69	
RAT713	1,000	22-18	.140	1/4"		1.07	.46	.31	.84	
RBT853	1,000	16-14	.170	#6		.84	.31	.25	.69	
RBT863	1,000	16-14	.170	#8		.84	.31	.25	.69	
RBT873	1,000	16-14	.170	#10		.84	.31	.25	.69	
RBT713	1,000	16-14	.170	1/4"		1.08	.46	.31	.81	
RCT333	500	12-10	.210	#6		1.00	.37	.27	.81	.04
RCT863	500	12-10	.210	#8		1.00	.37	.27	.81	
RCT363	500	12-10	.210	#10		1.00	.37	.27	.81	
RCT713	500	12-10	.210	1/4"		1.11	.52	.32	.85	
RCT703	500	12-10	.210	5/16"		1.23	.52	.31	.96	
RCT733	500	12-10	.210	3/8"		1.29	.58	.35	1.00	

Tefzel® 为杜邦公司注册商标

# 环形端头

## 尼龙绝缘矩形环形端头

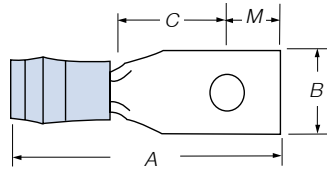

产品编号	包装件数	螺栓孔	导线规格范围	推荐工具	尺寸				BU 船用舌端	材料厚度
					A	B	C	M		
RA486	1,000	#4	22-18	ERG4001	.796	.237	.237	.143	L86P-1	.03
RA485	1,000	#4	22-18		1.015	.237	.404	.195	L85P-1	
RA483	1,000	#5	22-18		.859	.277	.277	.143	L83P-1	
RA484	1,000	#6	22-18		1.015	.237	.404	.195	L84P-1	
RA481	1,000	#6	22-18		1.109	.302	.465	.227	L81P-1	
RA482	1,000	#8	22-18		1.109	.302	.465	.227	L82P-1	
RA480*	1,000	#8	22-18		1.359	.390	.621	.310	L80P-1	
RB486	1,000	#4	16-14		.796	.237	.237	.143	L86P-2	
RB485	1,000	#4	16-14		1.015	.237	.404	.195	L85P-2	
RB483	1,000	#5	16-14		.859	.277	.277	.143	L83P-2	
RB484	1,000	#6	16-14		1.015	.237	.404	.195	L84P-2	
RB481	1,000	#6	16-14		1.109	.302	.465	.227	L81P-2	
RB482	1,000	#8	16-14		1.109	.302	.465	.227	L82P-2	
RB480*	1,000	#8	16-14		1.359	.390	.621	.310	L80P-2	
RC486	500	#4	12-10	ERG4005	.984	.237	.237	.143	L86P-3	.04
RC485	500	#4	12-10		1.187	.237	.404	.195	L85P-3	
RC483	500	#5	12-10		1.046	.277	.277	.143	L83P-3	
RC484	500	#6	12-10		1.203	.237	.404	.195	L84P-3	
RC481	500	#6	12-10		1.281	.302	.465	.227	L81P-3	
RC482	500	#8	12-10		1.281	.302	.465	.227	L82P-3	
RC480*	500	#8	12-10		1.531	.390	.621	.310	L80P-3	

\* 不可用胶带缠绕

注: RA, RB, RC486型适用于26TB型BU船用接线板。RA, RB, RC485型适用于25TB及27TB型。RA, RB, RC483型适用于8TB型。RA, RB, RC484型适用于10TB及11TB型。RA, RB, RC481型适用于6TB、7TB及9TB型。RA, RB, RC482适用于15TB型。RA, RB, RC480适用于3TB、4TB、5TB、16TB、17TB及18TB型。

注:

22-18 ga. = 1-2 Navy

16-14 ga. = 2 1/2-4 Navy

12-10 ga. = 6-9 Navy

## 非绝缘矩形环形端头

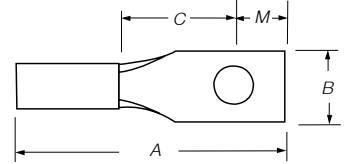

产品编号	包装件数	螺栓孔	导线规格范围	推荐工具	尺寸				BU 船用舌端	材料厚度
					A	B	C	M		
A486	1,000	#4	22-18	ERG4002	.65	.237	.237	.143	L86	.03
A485	1,000	#4	22-18		.87	.237	.404	.195	L85	
A483	1,000	#5	22-18		.70	.277	.277	.143	L83	
A484	1,000	#6	22-18		.87	.237	.404	.195	L84	
A481	1,000	#6	22-18		.96	.302	.465	.227	L81	
A482	1,000	#8	22-18		.96	.302	.465	.227	L82	
A480*	1,000	#8	22-18		1.21	.390	.621	.310	L80	
B486	1,000	#4	16-14		.65	.237	.237	.143	L86	
B485	1,000	#4	16-14		.87	.237	.404	.195	L85	
B483	1,000	#5	16-14		.70	.277	.277	.143	L83	
B484	1,000	#6	16-14		.87	.237	.404	.195	L84	
B481	1,000	#6	16-14		.96	.302	.465	.227	L81	
B482	1,000	#8	16-14		.96	.302	.465	.227	L82	
B480*	1,000	#8	16-14		1.21	.390	.621	.310	L80	
C486	500	#4	12-10	ERG4005	.73	.237	.237	.143	L86	.04
C485	500	#4	12-10		.90	.237	.404	.195	L85	
C483	500	#5	12-10		.76	.277	.277	.143	L83	
C484	500	#6	12-10		.94	.237	.404	.195	L84	
C481	500	#6	12-10		1.03	.302	.465	.227	L81	
C482	500	#8	12-10		1.03	.302	.465	.227	L82	
C480*	500	#8	12-10		1.27	.390	.621	.310	L80	

\* 不可用胶带缠绕

注: A, B, C486适用于26TB型BU船用接线板。A, B, C485适用于25TB及27TB型。A, B, C483适用于8TB型。A, B, C484适用于10TB及11TB型。A, B, C481适用于6TB、7TB及9TB型。A, B, C482适用于15TB型。A, B, C480适用于3TB、5TB、16TB、17TB及18TB型。

注:

22-18 ga. = 1-2 Navy

16-14 ga. = 2 1/2-4 Navy

12-10 ga. = 6-9 Navy

# 旗型端头

## 非绝缘旗型端头

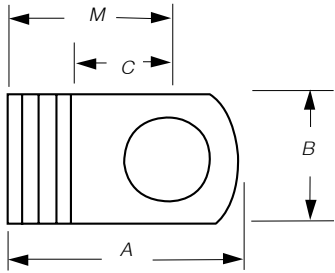
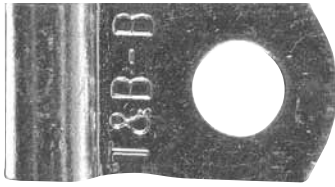

产品编号	数量	导线规格范围	螺栓孔	推荐工具	尺寸				材料厚度
					A	B	C	M	
AB14-6A	100	22-14	#6	ERG4004	.55	.31	.22	.39	.03
AB51	1,000	22-14	#6		.55	.31	.22	.39	
AB14-8A	100	22-14	#8		.55	.31	.22	.39	
AB52	1,000	22-14	#8		.55	.31	.22	.39	
AB14-10A	100	22-14	#10		.55	.31	.22	.39	
AB53	1,000	22-14	#10		.55	.31	.22	.39	.04
C51	500	12-10	#6		.66	.31	.25	.48	
C10-8A	50	12-10	#8		.66	.31	.25	.48	
C52	500	12-10	#8		.66	.31	.25	.48	
C10-10A	50	12-10	#10		.66	.31	.25	.48	
C53	500	12-10	#10	.66	.31	.25	.48	.06	
D236	200	8	#10	.83	.50	.25	.59		
D226	200	8	#10	.90	.50	.29	.64		
D271	200	8	1/4"	.92	.50	.33	.68		
E226	200	6	#10	.93	.50	.29	.69		
E271	200	6	1/4"	.99	.50	.33	.73		
E272	200	6	5/16"	1.05	.50	.41	.81		.07
F226	200	4	#10	1.07	.56	.33	.80		
F271	200	4	1/4"	1.10	.63	.33	.80		
F272	200	4	5/16"	1.18	.63	.41	.88		
F273	200	4	3/8"	1.20	.63	.43	.90	.08	
G671	100	2	1/4"	1.20	.63	.33	.89		
G672	100	2	5/16"	1.28	.63	.41	.97		
G673	100	2	3/8"	1.32	.63	.46	1.02	.10	
H672	50	1/0	5/16"	1.31	.63	.41	1.01		
H673	50	1/0	3/8"	1.36	.63	.46	1.06		
J672	50	2/0	5/16"	1.46	.75	.41	1.10		
J673	50	2/0	3/8"	1.51	.75	.46	1.15		
J675	50	2/0	1/2"	1.67	.75	.55	1.24		
K672	50	3/0	5/16"	1.59	.81	.41	1.19		.11
K673	50	3/0	3/8"	1.64	.81	.46	1.24		
K675	50	3/0	1/2"	1.76	.81	.55	1.34		
M673	50	250kcmil	3/8"	1.89	1.0	.46	1.43	.13	
M675	50	250kcmil	1/2"	1.99	1.0	.55	1.52		